

# **MP4 Video Player Manual**

**for Nanolike MP4 Players**

## **User Guide**

---

Fuji Labs VM3350 is a new generation media players, supporting MP1, MP2, MP3, WMA, WMV, ASF or WAV files. It has perfect tone and high reliability with refined exterior design that brings you an excellent performance.

## Overview

- Slim exterior design

Compact size. Fits in your hand.

- Support multi file format!

This player recognizes MP1, MP2, MP3, WMA and video in WMV, ASF, WAV and AMV formats.

- FM stereo radio

Powerful automatic or manual tuning capability, save up to 40 channels (20 channels in each system).

- e-Documents

You can download text files into the player and read it at any time.

- Driver free USB memory

Manage your files in USB memory without specified software, no need for drivers with WIN2000 or above.

- 'Secret Space'

You can separate part of the memory encrypting and hiding using programs provided, where data cannot be seen or written by others.

- Recorder / Repeat

Voice can be recorded and saved in WAV or ACT format. Phase/Contrast repeat available.

- Equalizer

Normal, Rock, Pop, Classic, Soft, Jazz, Bass

- Play modes

Normal, Single Repeat, Play Catalog, Repeat Catalog, Repeat All, Shuffle, Lyric.

- Timing turning off

The player provides Sleep and battery saving mode.

- Complete dynamical menu

Visual dynamical menus and text instructions help with control.

## Declarations

Thank you for choosing our product, please read this manual carefully.

Functions and performance may change without prior notice.

If there are any differences between product and this manual, please visit our website

---

# Contents

● Overview.....	2
● Declarations.....	2
● Know your player.....	5
Exterior and Keys.....	5
Display.....	5
Battery Level.....	5
● Basic Functions.....	5
Access to Menus.....	5
Scrolling.....	5
List of Menus.....	5
Volume Adjust.....	6
Switch On/Off.....	6
Play & Stop.....	6
Start/Stop Recording.....	7
Recording / Pause.....	7
● Keys Processing.....	8
Keys function definition.....	8
Keys processing definition.....	8
● Play music.....	8
Simple Actions.....	8
Equalizer mode.....	8
Synchronous Lyric Settings.....	9
How to display lyric?.....	9
● Voice Recorder.....	10
Recording on 'Record Mode'.....	10
Start Recording Type.....	11
Voice control.....	11
Play recorded files.....	11
● Using FM radio.....	11
● Settings.....	12
Entry settings.....	12
Option introductions.....	13
'System time'.....	13
'LCD Set'.....	14
'Language'.....	14
'Turning Off'.....	14
'Repeat'.....	14
'PC Connection'.....	14
'Memory Status'.....	14
● Reading Documents.....	15
● Browsing Pictures.....	15

---

- Using USB Disk.....16
- Other Settings.....17
  - Change Folders.....17
  - Delete Files.....17
  - Play Mode.....18
  - Tempo rate.....19
  - Repeat Mode.....19
    - A-B Repeat.....19
- New Function Recommends.....19
  - Secret Space Function.....19
  - Convert Video files into AMV.....21
- Troubleshooting.....24
- Technical Specifications.....24

---

## Know your player

### ● Exterior and Key

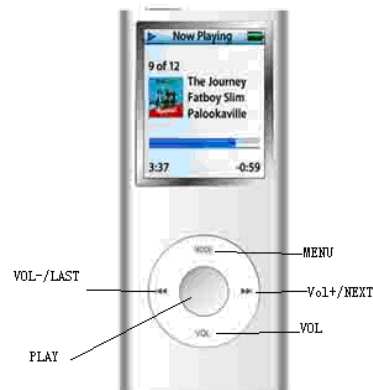

### ● Battery Level

The player shows capacity in 9 levels

Battery is full on 3.8V. As time goes on, capacity indicator will diminish.

Indicator shows blank when battery is almost out. You should charge your battery at that time.



Please turn the switch on the player before charge. This player cannot be charged if the switch is turned off.



Please switch off power when not using the player.

## Basic Functions

### ● Access to Menus

Press **Menu** to access menus.

### ● Scrolling

○ Scroll music, menus

○ Fast Forward / Reverse when playing music.

### ● List of Menus

To access different menu functions from main menu.

Main menu: (Hold **Menu** to access)



---

Video play:

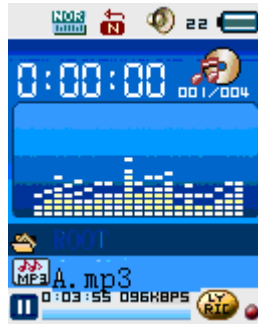

Recorder Mode:

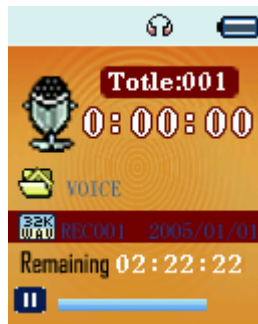

Play Mode:

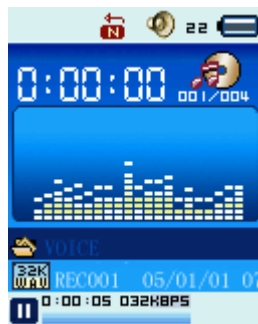

FM Mode:



Browsing pictures:

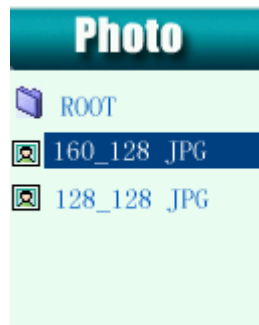

E-Documents:

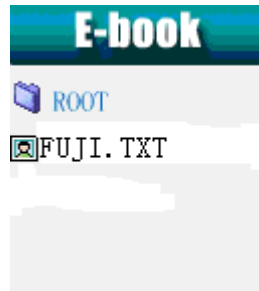

USB Mode (Connect to PC):



- **Volume Adjust**  
By Pressing **VOL** once, then press **VOL+** to increase volume, or press **VOL-** to decrease.
- **Switch on/off**  
Press and hold **Play** to turn on the player.  
Press and hold **Play** to turn off the player.
- **Play & Pause; exit from submenu**  
On music mode, Press **Play** to play music.  
When playing music, press **Play** to pause; press and hold to stop playing.
- **Start / Stop recording**  
On recording mode, press **Play** to stop.

---

## Keys Processing

### ● Keys Functions Definition

1. **Play**: Power On/Off, Play, Pause, Stop
2. **Menu**: To enter main menu or exit from current menu.
3. **VOL+**: Volume increase (press VOL key, then press VOL+)
4. **VOL-**: Volume decrease. (press VOL key, then press VOL-)
5. **Next**: Next, FF, Volume increase
6. **Last**: Previous, Rev, Volume decrease
7. **USB**: USB outlet
8. **Earphone**: Standard earphone outlet
9. **ON/OFF**: Power switch

### Key Processing Definition

Keys processing includes 4 actions: Press, Press and Hold, Push, Hold.

**Press**: Press a key and valid immediately;

**Press and Hold**: Press a key and hold it at least 1.2s this action valid only once.

**Push**: Push a key, and valid when released.

**Hold**: Frequency will cause key to hold Fast Forward and Reverse.

## Play music

### ● Simple actions

1. Plug earphone plug into earphone outlet;
2. Press and hold **Play** to switch the player on, then enter Music Mode and press **Play** to play music.
3. Select a music: **Last**: Previous music;  
**Next**: Next music.
4. For AMV files, video play will apply.

### ● Equalizer Mode

1. When playing music

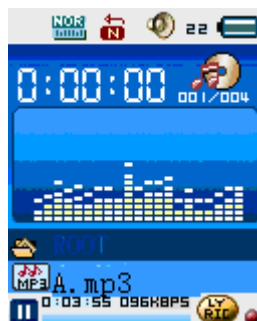

2. Press **Menu** to enter play submenu;
  3. Push **Next** choosing Equalizer Mode;
  4. Press **Menu** to enter 'Equalizer Mode' submenu.
-

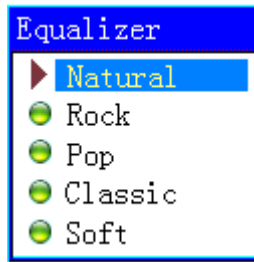

Select an equalizer:

5. Detail of each equalizer (EQ):

Natural
Rock
Pop
Classical
Soft
Jazz
DBB

6. Push **Next** to select an EQ and press **Menu** to confirm.

● **Synchronous Lyric Display**

The player supports lyric files with \*.LRC suffix, and displays synchronously.

How to use lyric files?

Please make sure the lyric has the same name to the music

For example:

Music file: Journey.mp3

Lyric file: Journey.lrc

How to know if lyric is available?

If lyric matched, a red icon  will be displayed on the bottom left corner of screen,

1. When marched lyric available:

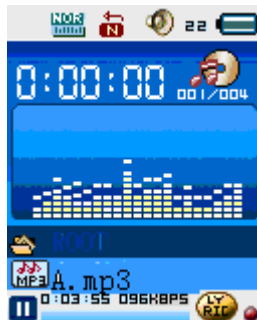

2. Press and hold **Menu** to entry lyric interface;

---



it's a long long journey

till i know whera i'm  
supposed to be

3. Lyric displays
4. Press **Menu** return to music mode.

## Voice Recording

Please make sure the battery has enough capacity before recording.  
Each fold can save up to 99 voice recording files.

### ● Recording on “Record mode”

1. .Entry main menu:



2. Push **Next** scroll to Record mode
3. Push **Menu** to select Record mod

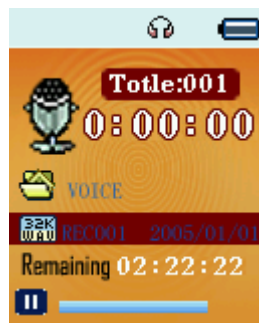

4. Press **Play** to start recording.



Voice will be recorded in current folder which set through 'Record stop / Main folder'



If displayed “Memory full”, it means there is no more space to save new record files, please delete other files to release memory space.



If “Folder full” shown, it means there are 99 record files in this folder. Please choose another one.



The player only responses to **Play** and **A-B** when record processing

---

## ● Select Record Type

1. When in the interface of 'Record stop'
2. Press **Menu** to enter record submenu

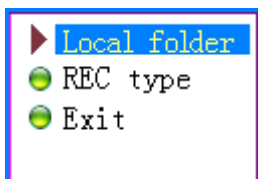

3. Push next scrolling into 'Record type' submenu then presses **MENU** to select it.

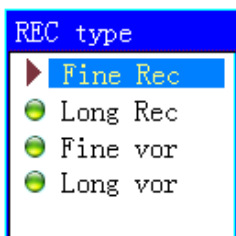

Fine record	wav file, fine quality
Long-time record	act file, normal quality
Fine voice control	wav file, (Recording controlled by voice, pause when mute)
Long-time voice control	act file, (Recording controlled by voice, pause when mute)

4. Press **Next** to choose appropriate type and press **Menu** to select it
5. Press **Play** to start recording.

## Play recorded files

1. Enter main menu
2. Push **Next** to choose 'Play mode'
3. Push **Menu** to enter playing interface
4. Press **Play** again to play the file.
5. Choose voice record files.
  - Last:** Select previous file;
  - Next:** Select the next file;

## Using FM radio

1. Enter main menu;
2. Push **Next** scrolling "FM Mode"
3. Push **Menu** to enter



#### 4. Auto tuning

Hold **Last/Next** 2 seconds to start the channel search in 100 KHz interval upwards or downwards. To stop tuning, push **Last/Next**.

#### 5. Manual tuning

Push **Last**: Downward 100 KHz

Push **Next**: Upward 100 KHz

#### 6. Save current channel:

Push Menu to enter FM submenu

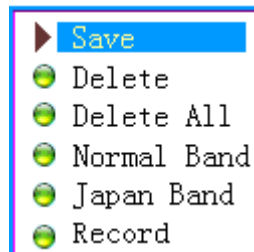

Press **Menu** again to save channel.

#### 7. Listening to a saved channel:

You can press **Play** to choose a saved channel.

#### 9. Volume control

**VOL+**: Increase volume;

**VOL-**: Decrease volume



: 20 channels can be saved each in “General Frequency” and “Japan Frequency”

## Settings

### ● Enter Settings

You can set system performances here, options may vary in different firmware version

1. Enter main menu

2. Push **Next** Scrolling into “Settings”

3. Press **Menu** to enter.

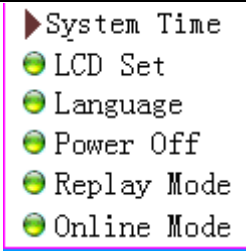

● **Options introduction:**

● (Recording Time)	Setting date and time when saving recorded file
● (Screensaver)	Screensaver setting
● (Language)	Choosing different languages
● (Timing shut off)	Setting a count down time in minutes, the player will shut off when time out.
● (Repeat Setting)	Setting repeat status
● (Contrast Setting)	Setting display's contrast
● (PC Mode)	Options for 'Secret Space'
● (Memory Status)	Check memory space and usage status
● (Firmware Ver.)	Version of player's firmware
● (Upgrade Firm.)	Use for upgrade firmware
● (Exit)	Exit from Setting interface

● **List of menus:**

○ 'System time' Setting

1. System setting interface

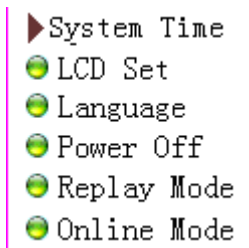

2. Press **Menu** to enter 'Recording time' interface

System time:

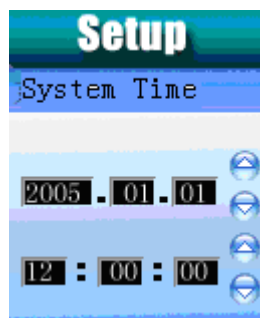

3. Push **VOL+** setting from years (**VOL-** from seconds). While setting, year on twinkling.

- 
4. Push **Next** the value will increase (**Last** on opposite)
  5. After setting, press **Menu** to exit.
- “LCD SET” Setting
    1. Press **Menu** to enter screensaver setting;
    2. Push **Next** for choosing (**Last** for previous)
    3. After setting, press **Menu** to exit.

- Language Setting

This player has 19 display languages: Simplified Chinese, English, Traditional Chinese, Japanese, Korean, French, Germany, Italian, Spanish, Portuguese, Dutch, Swedish, Czech, Danmark, Hebrew, Turkish, Polish, Thai and Russian.

1. Press **Menu** to enter ‘Language’ interface



2. Push **Next** / **Last** to scroll.
3. After setting, press **Menu** to exit.

- Turning off Setting

Please note:

You can set time in seconds on ‘Battery saving’ mode, allow the player shut down automatically when player become stop and idle for the period you have set. This function is void if the time set to 0.

You can set time in minutes on ‘Sleep mode’, allow the player shut down automatically when the player become idle (regardless current status) for the period you have set. It is designed for listening music before sleep. Please note: Sleep mode valid only once after setting, you have to set again if you want to use it next time.

- ‘Repeat Settings’

Please consult into ‘Sound Setting’

Note: in “Manual Mode” you should set repeat point manually.

In “Automatic Mode” the player can identify sentence automatically when on A-B repeat. (This function is designed for repeat sentences in language studies.)

- ‘PC connection’ Setting

Please consult into ‘Sound Setting’

Some operation systems (Windows 2K SP4 or prior) may not recognize a USB disk with two symbols. Therefore, you have to choose an active disk here when using ‘Secret Space’ function only the active disk can be found in PC.

- ‘Memory status’

You can check total memory space and the percentage of usage.



Tips: Press Play can exit current menu quickly. The function is valid on all other menus.

## Play Videos

1. Enter main menu, press **Next** scrolling to “MOVIE” (Only available to AMV files):



2. Press **MENU** to enter:

3. Press **PLAY** to start



## ● Reading Documents

- 1 .On main menu, press **Next/Last** choosing e-Document,
- 2 .Press **Menu** to enter corresponding submenu:

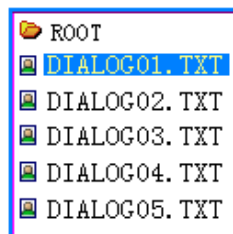

- 3 . Press **Next** or **Last** choosing the document you want to read, then press **Play** to read it.

Note: If you are set in 'Manual play' you must scroll text via Next or Last; texts can be scrolled automatically under 'Auto play' set.

## ● Browsing Pictures

---

This function is only available for JPEG format.

1. On main menu, press **Next/Last** choosing Browsing pictures.
2. Press **Menu** to enter corresponding submenu:

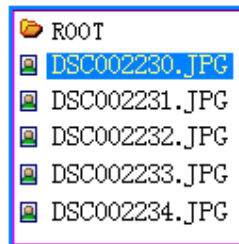

3. Press **Next** or **Last** choosing the document you want to read, then press **Play** to play it..

## 9、 Using USB Disk

The player is also a standard USB disk. Supported by Windows98 (drivers needed), Windows 2K or above (no need for drivers), Mac OS 10.3, Red hat Linux 8.0 or above.

The player supports USB power supply, can be used without battery when connected to PC. To entry, when on 'waiting mode' press **Menu** return to main menu and choose the operation you need.

This player supports Suspend mode.

When connected to PC, The player works on the three modes below:

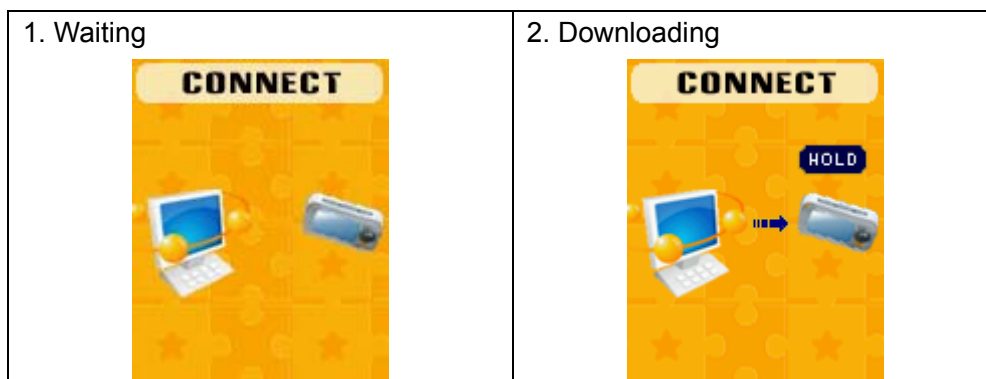



3. Uploading



## Other settings

- **Choose other fold (Stop submenu)**

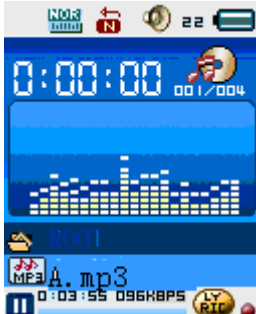
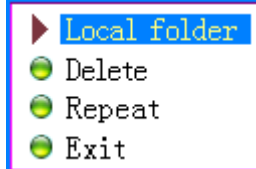

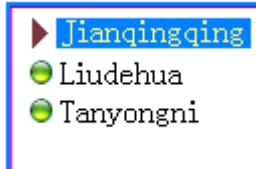
You can classify files into several different folders that ease to manage them (folders should be created on PC). The player can identify 9 folders in root

<p>1. When stopped</p> 	<p>2. Press <b>Menu</b> to enter Stop submenu</p> 
<p>3. Press <b>Menu</b> to enter folder choosing interface</p> 	<p>4. Press <b>Next</b> or <b>Last</b> to choose a folder</p> 
<p>5. Press <b>Menu</b> to enter selected folder.</p>	

**Please note:** You can set folders independently in Music / Recorder / Play mode

- **Delete file (Stop submenu)**

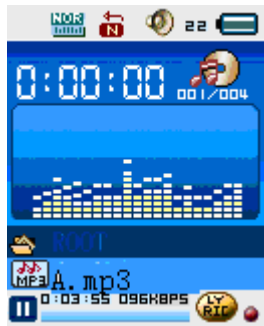
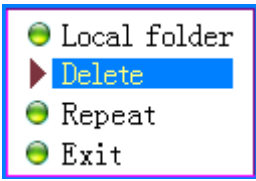
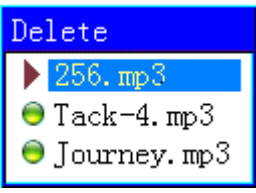
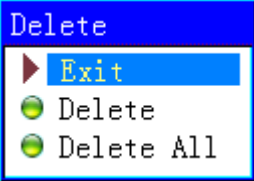
You delete correspond files/channels in each Music/Play/FM modes..

<p>1. When Stopped. (No stop interface in FM mode)</p> 	<p>2. Press <b>MENU</b> to enter Stop submenu</p> 
<p>3. Press <b>Next</b> or <b>Last</b> to choose 'Delete file' or 'Delete all'.</p> 	<p>4. Press <b>Menu</b> to enter delete interface.</p> 
<p>5. Press <b>Menu</b> to confirm delete</p> 	

'Delete all' will delete all files in current folder of current mode. I.e. Choose 'Delete all' in Music mode will delete all music files; recorder files will not be affected.

On FM mode, all saved channel will be removed.

⚠ Please safely removed player and unplug USB cable after delete files on PC, otherwise some files will not be removed.

● **Play mode (Play submenu)**

You can choose different play mode (i.e. repeat, shuffle) when playing music or recorded files. The first option on Play submenu is 'Play mode'

○ **REPEAT**

(Normal)	Playing music files in sequence until the end of folder
(Repeat One)	Repeat single music file
(Folder)	Play all music files in folder
(Repeat Folder)	Repeat all music files in folder
(Repeat All)	Repeat all music files

○ **SHUFFLE**

(Random)	Play music files in folder randomly
----------	-------------------------------------

---

○INTRO

 (Intro)	Play the 10s of each music files in sequence
---	--

● **Tempo rate(Play submenu)**

You can choose different play speed and not affect to sound. (Only valid to MP3 files)

1. While playing music
2. Push **Menu** to enter play submenu
3. Push **Next** scrolling to 'Play speed' option
4. Push **Menu** to enter
5. Push **Next** for faster, **Last** for slower

Note:

Play speed will apply to all music file

● **Repeat mode (Play submenu)**

Enter from Play submenu:

○ **A-B Repeat**

1. When play music or recorder
2. Push **Menu** to enter play submenu
3. Push **Next** and scroll to 'Repeat Mode' option
4. Push **Menu** to enter

Repeat Mode: 'A' of Symbol  flashes, waiting for starter A

5. Push **Next** to select 'A'

'B' of symbol  flashes, wait to enter B

6. Push Next to select B

Symbol  fixed and starting repeat between A-B, while playing, you can push **Last** to reset A point.



In repeat mode, you can press **VOL+** or **VOL-** to adjust playing speed

● **New Function Recommends!**



**About Secret Space**

Some MP3 user may worry about revealing secret. They do not want others to find private information contained, therefore these data have to be removed before lending their own MP3 to others. The process may cause some trouble.

However, this problem is solved by using the 'Secret Space' technique!

You can use provided software to divide the whole USB disk into two parts, and encrypt one of them. You can move your privacy into the encrypted part; they will be protected by password.

To active 'Secret Space':

1. Connect your player to PC
2. Run *MP3 Player Disk Tool* which can be found in provided CDROM

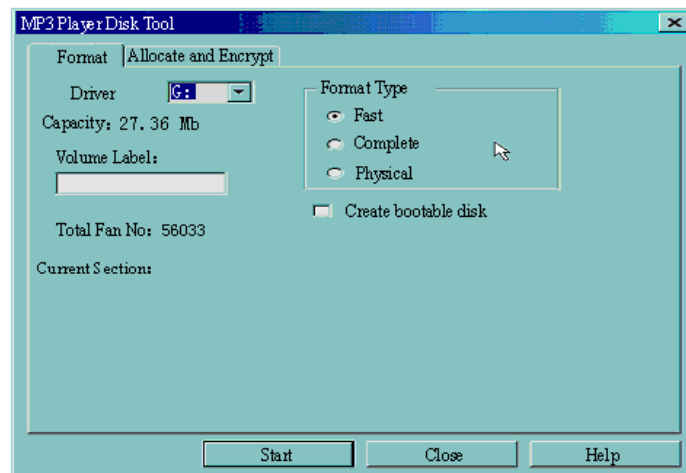

3. Click 'Allocation and Encrypt' card, Allocate appropriate space and set username and password, and then click Start.

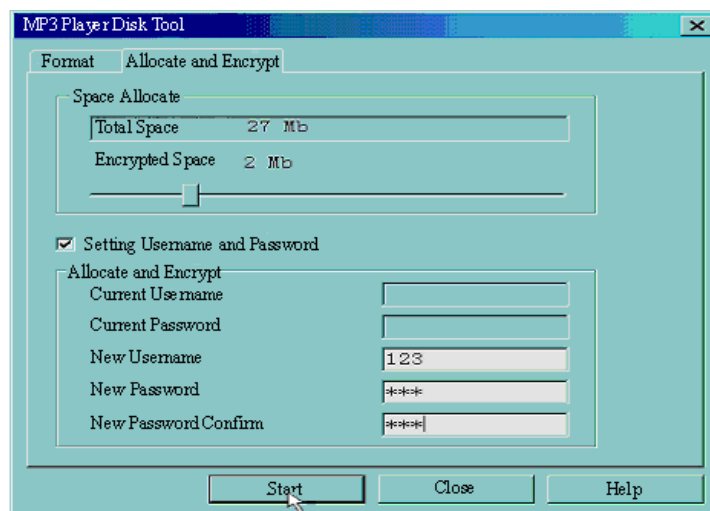

4. After space allocation, shown as below:

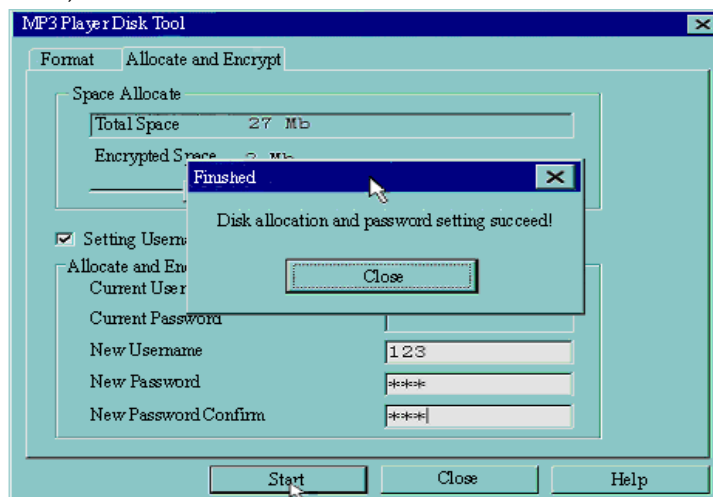

5. Click 'OK' to restart.
6. After restart you will find two disks (only one disk can be seen on Windows 2K SP4 or prior), click the encrypted disk (the second one), you will find three files, two are hidden, one is executable

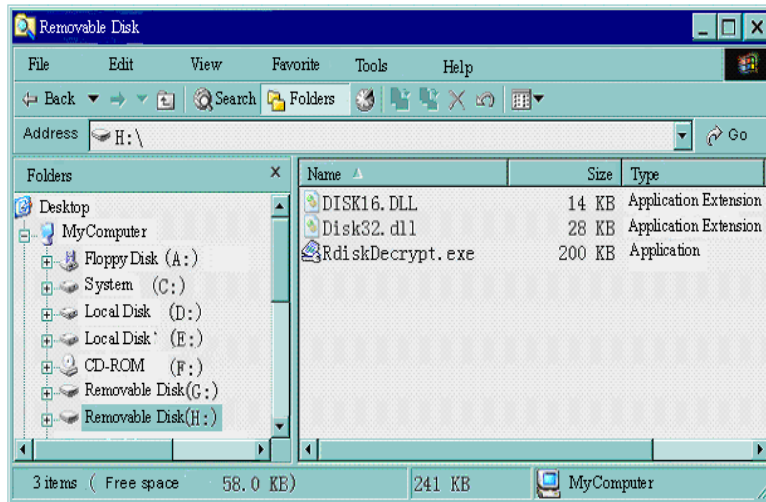

- Running executable file 'RdiskDecrypt.exe' and input username and password. If all are correct, disk will be opened, and files can be copied into.



- You must enter username and password each time access encrypted disk.





Warning: Divide one disk into parts will remove all data, and so does combine process.





Warning: Please remember username and password. If you forget it, you can only making combine processing and you will loss all encrypted data.

## Convert Video files into AMV

This program is used to convert video files into AMV format, currently only WMV format is supported.

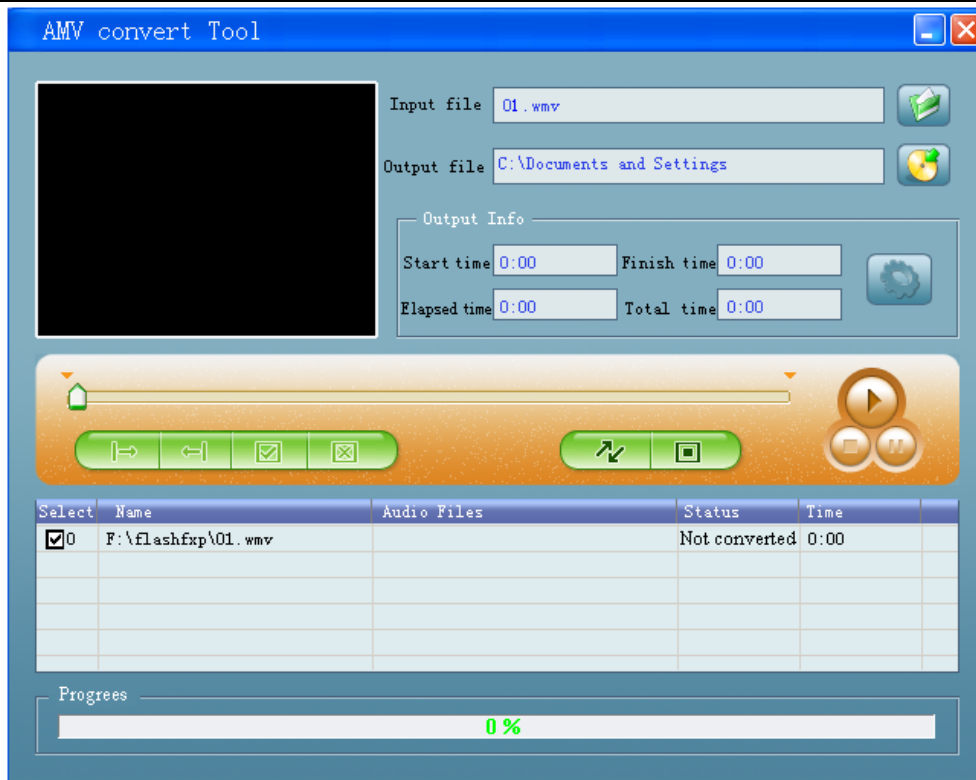
- Run "AMV Convert Tools", click  to choose the folder where to save the AMV files, then click  to select the folder where the original files are .



2 . Select unprocessed AMV files, then click , the icon will be highlighted into  and a dialog box will shown. Choosing Pixels of AMV to “128 \* 160” and Frames per second to “middle”, then click OK to confirm. (Note: Only pixels in 128\*96 can be supported)

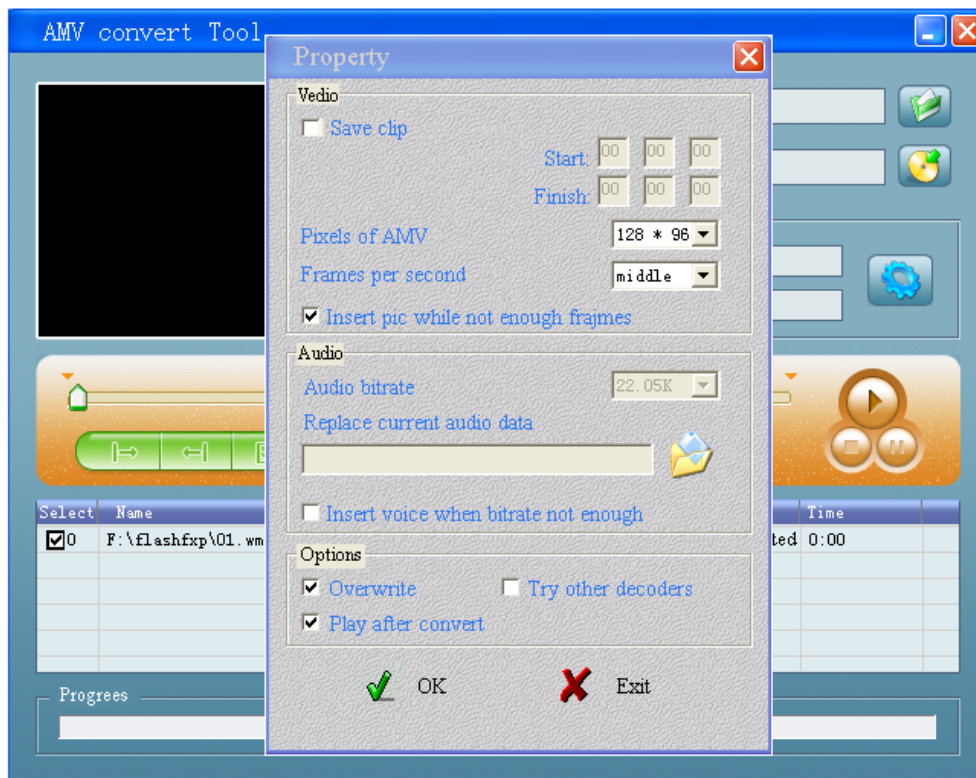

3 . Click  to start converting.

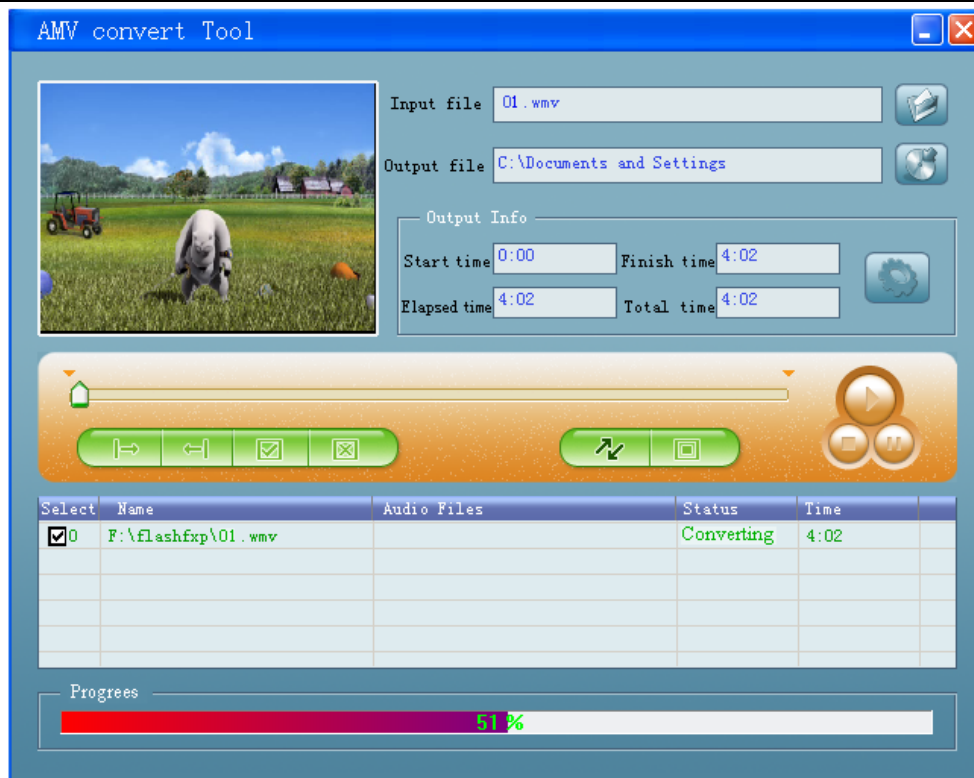

4. After convert, the AMV files will be played automatically.

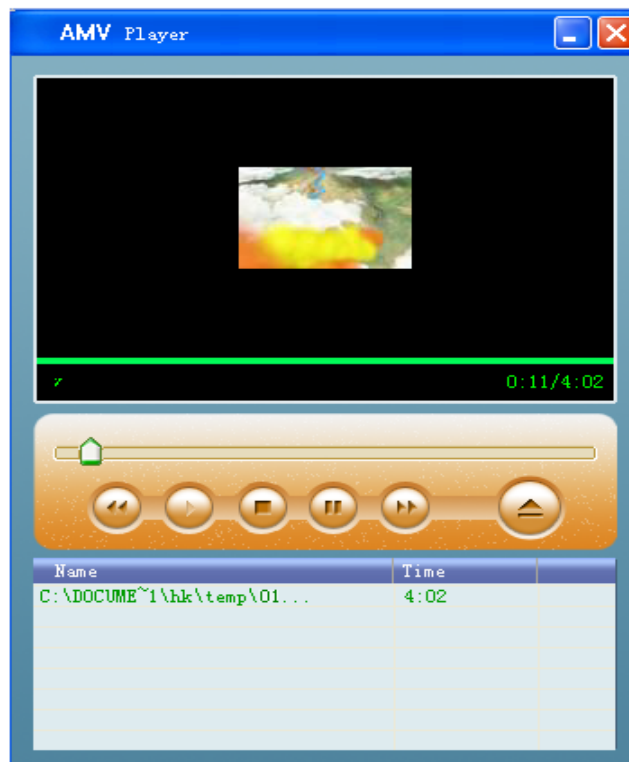

## ●Troubleshooting

No Power	Check if battery had installed properly Make sure you have switched the player on
No Sound	Make sure volume is not on 0 position and the connection to earphone is valid Please make sure the earphone is clean Damaged MP3 files may have noise and even cannot be played
Strange characters on display	Make sure you have chose correct language
FM has bad performance	Adjust place of player and earphone Switch off power appliance nearby Earphone can be used as antenna
Cannot Download Music	Check USB cable, and make sure the player is properly connected to the PC Check if the driver has well installed Make there is still blank memory

## Technical Specifications

Dimension		
Weight		
Screen	1.5 CSTN (128*128)	
Connecting to PC	High Speed USB1.1 (Read 1000K Byte, Write800K Byte)	
Memory	128M – 256M Flash	
Power Supply	Max 10 hours play mode	
Voice Recorder	Sample rate	8KHz
	Format	WAV (32K bps), ACT (8K bps)
	Time	35hours (ACT, 128M Flash)
MP3、WMA、WMV、ASF	Max. Output	(L) 10mW + (R)10mW (32Ohm)
	MP3 Bit rate	8K bps – 320K bps
	WMA 、 WMV 、 ASF Bit rate	5K bps – 384K bps
	Freq. Response	20Hz to 20KHz
	SNR	85dB
	Distortion	

FM Radio	Freq. Range	76MHz – 90MHz / 87MHz – 108MHz
	Max. Stored Channels	20 + 20
	Max. Output	(L) 10mW + (R)10mW (32Ohm)
	SNR	45dB
Supported Music Formats	MP1, MP2, MP3, WMA, WMV, ASF, WAV	
Operate Temperature	-5 to 40 degree	
17 Languages Display	English, Simplified Chinese, Traditional Chinese, Japanese, Korean, Italian etc.	
Supported Systems	Windows98/SE/ME/2K/XP、Mac OS 10、Linux 2.4.2	

Please note: Design and characters may change without prior notice.